

# Customization Workbook for HANDGEAR™

Contact 2T for logo placement

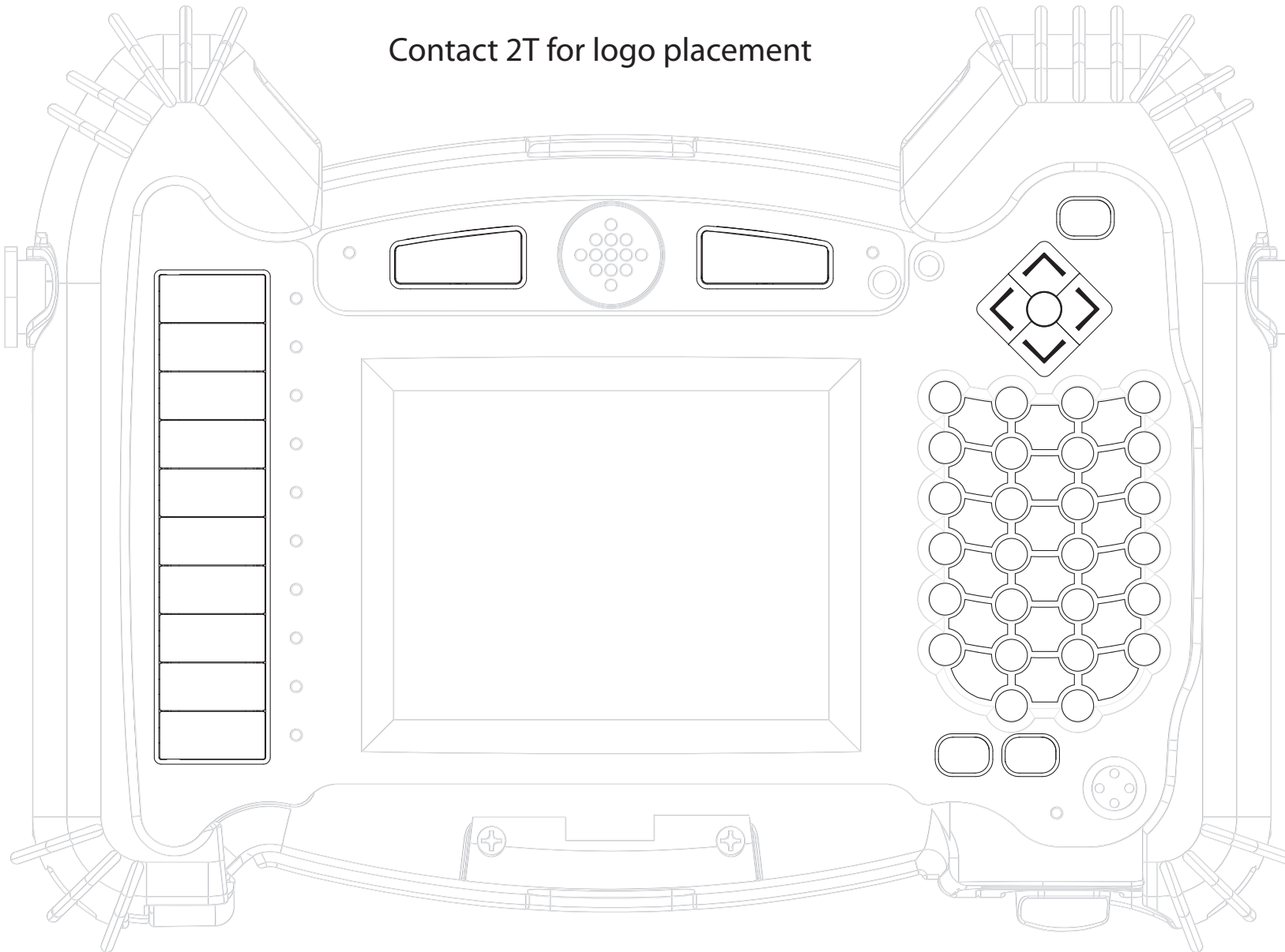

Case color

\_\_\_\_\_

Bumper Color

\_\_\_\_\_

Display Bezel Color

\_\_\_\_\_

Bezel Pantone Colors

- 1. \_\_\_\_\_
- 2. \_\_\_\_\_
- 3. \_\_\_\_\_
- 4. \_\_\_\_\_
- 5. \_\_\_\_\_

Hot Keys Pantone Colors

- 1. \_\_\_\_\_
- 2. \_\_\_\_\_
- 3. \_\_\_\_\_
- 4. \_\_\_\_\_
- 5. \_\_\_\_\_

FasTap® Pantone Colors

- 1. \_\_\_\_\_
- 2. \_\_\_\_\_
- 3. \_\_\_\_\_
- 4. \_\_\_\_\_
- 5. \_\_\_\_\_

Please fill in as much information as possible and fax to 215.441.0423. Please contact your sales representative at 215.441.5305 for more information on customization.

# Customization Workbook for HANDGEAR™



(Base label color is black)

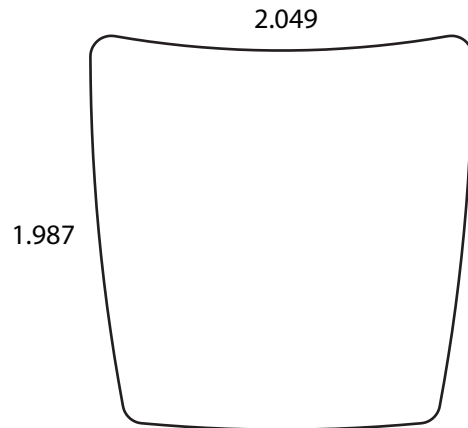

Specify graphics on **HG PACK Label**  
(not available when printer is selected)

PACK Pantone Colors

1. \_\_\_\_\_
2. \_\_\_\_\_
3. \_\_\_\_\_
4. \_\_\_\_\_
5. \_\_\_\_\_

Font and Point size  
(or provide graphics)

1. \_\_\_\_\_
2. \_\_\_\_\_
3. \_\_\_\_\_
4. \_\_\_\_\_
5. \_\_\_\_\_

Graphics to be supplied in vector format (EPS, AI)

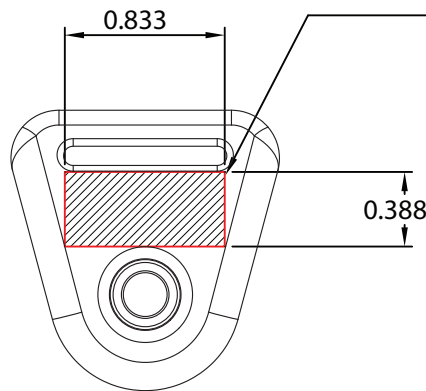

Specify graphics on **HG Strap Adapter** within red box

PACK Pantone Colors

1. \_\_\_\_\_
2. \_\_\_\_\_
3. \_\_\_\_\_
4. \_\_\_\_\_
5. \_\_\_\_\_

Font and Point size  
(or provide graphics)

1. \_\_\_\_\_
2. \_\_\_\_\_
3. \_\_\_\_\_
4. \_\_\_\_\_
5. \_\_\_\_\_

Logo embroidery on strap is available. Please contact your sales representative for more information on placement. 215.44.5305

# Customization Workbook for HANDGEAR™

Specify graphics on **HG Latching Cradle**  
(in red area only)

Pantone Colors

1. \_\_\_\_\_
2. \_\_\_\_\_
3. \_\_\_\_\_
4. \_\_\_\_\_
5. \_\_\_\_\_

Font and Point size  
(or provide graphics)

1. \_\_\_\_\_
2. \_\_\_\_\_
3. \_\_\_\_\_
4. \_\_\_\_\_
5. \_\_\_\_\_

Graphics to be supplied in vector format (EPS, AI)

